



The ideal pipette for every hand!

Transferpette®

Pipetting System

BRAND offers the ideal pipette for every hand:

- Transferpette® with the pipetting key on the side
- Transferpette® S with the central pipetting button and one-handed volume setting
- Transferpette® electronic with motor drive

BRAND has been developing and manufacturing single-channel and multichannel piston-operated pipettes for more than 25 years. Special attention is always paid to optimum ergonomics and reduction of injuries caused by prolonged strain (such as Repetitive Strain Injury Syndrome, RSI).





Pipetting – A Routine Laboratory Procedure

Pipetting is one of the most frequent tasks in the laboratory. The right choice of pipette is critical to performing this repetitive task accurately and strain-free.

What are the special features to look for?

■ Pipetting key

To fit your preferred working style, choose either the Transferpette® with the pipetting key on the side or the Transferpette® S with the central pipetting button. The Transferpette® electronic only needs a brief tap on the pipetting button to activate the piston.

■ Tip ejector

All Transferpette® models have separate tip ejection. This reduces the risk of accidental tip ejection.

■ Adjustability

Piston-operated pipettes are calibrated in compliance with the monitoring of measuring instruments according to EN ISO 8655. All Transferpette® models feature the unique Easy Calibration Technique that allows adjustment without tools (please see page 276).

■ Autoclavability

No compromises! Depending on the model, either the complete pipette shaft (Transferpette®, Transferpette® electronic) or the entire pipette (Transferpette® S) can be autoclaved at 121 °C (20 min).

■ Tip cone

Pipette and pipette tip form a single system. Both components have been developed by BRAND and are perfectly matched. This ensures an optimum fit between the Transferpette® and the PLASTIBRAND® pipette and filter tips.

For your convenience, tip cone is also designed to accept tips made by other leading manufacturers.

Which Transferpette® is right for you?

Selection criteria	Transferpette® S	Transferpette®	Transferpette® electronic
Side pipetting key		✓	
Central pipetting button	✓		✓
Separate tip ejection	✓	✓	✓
Easy Calibration Technique	✓	✓	✓
Entire shaft is autoclavable	✓	✓	✓
Entire pipette is autoclavable	✓		
Corrosion-resistant piston	✓	✓	✓
Universal tip cone	✓	✓	✓
Volume display	4-position	3/4-position*	4-position
Volume range	0.1 µl - 10 ml	0.1 µl - 5 ml	0.5 µl - 5 ml
Motor driven			✓

* depending on volume range

Transferpette® S

Single channel

**A new performance standard among pipettes with a central pipetting button!
BRAND's new Transferpette® S.**

Transferpette® S models are the product of intensive ergonomic and operational studies and the application of modern innovative materials. The new Transferpette® S models are the perfect manual pipettes for demanding laboratory applications for scientists who prefer the central pipetting button.

The Transferpette® S pipettes provide all of the features required by users working in the life sciences field. Robust, one-handed operation, completely autoclavable, high precision and Easy Calibration technique for lasting reliability. Available as fixed-volume and digital models in volume ranges from 0.1 µl to 10 ml.

NEW!

Transferpette® S
Solutions for
Science



Models

Lightweight – robust – low force: Transferpette® S provides maximum versatility and optimum quality over the entire 0.1 µl to 10 ml volume range. Eight models are available in the respective digital adjustable and fixed volume types.

- Central pipetting button and separate ejection function
- One-handed operation for both right- and left-handers
- The Transferpette® S is completely autoclavable at 121 °C (20 min).
- 4-position volume display, always clearly visible
- Transferpette® S features Easy Calibration technique – readjustment without special tools (please see page 276 for further details) – Changes from factory settings are clearly visible externally.
- Corrosion-resistant piston and ejector
- Color-coded for easy selection of the right tip
- Transferpette® S 0.1-1 µl – maximum precision for molecular biology work, especially when pipetting enzymes.
- CE-IVD-compliant



Solutions
for *Science*
Transferpette® S



One-handed operation – easy volume changes with no fumbling.



Optimal performance will be achieved with the use of genuine PLASTIBRAND® premium tips.
Pipette and filter tips,
see page 81-88.

A Closer Look...

Every detail is carefully considered. A central pipetting button, the one-handed operation, precise 4-position volume settings and a volume display that can be easily read by both right- and left-handed operators are only a few examples of the attention to detail in the design of the Transferpette® S.

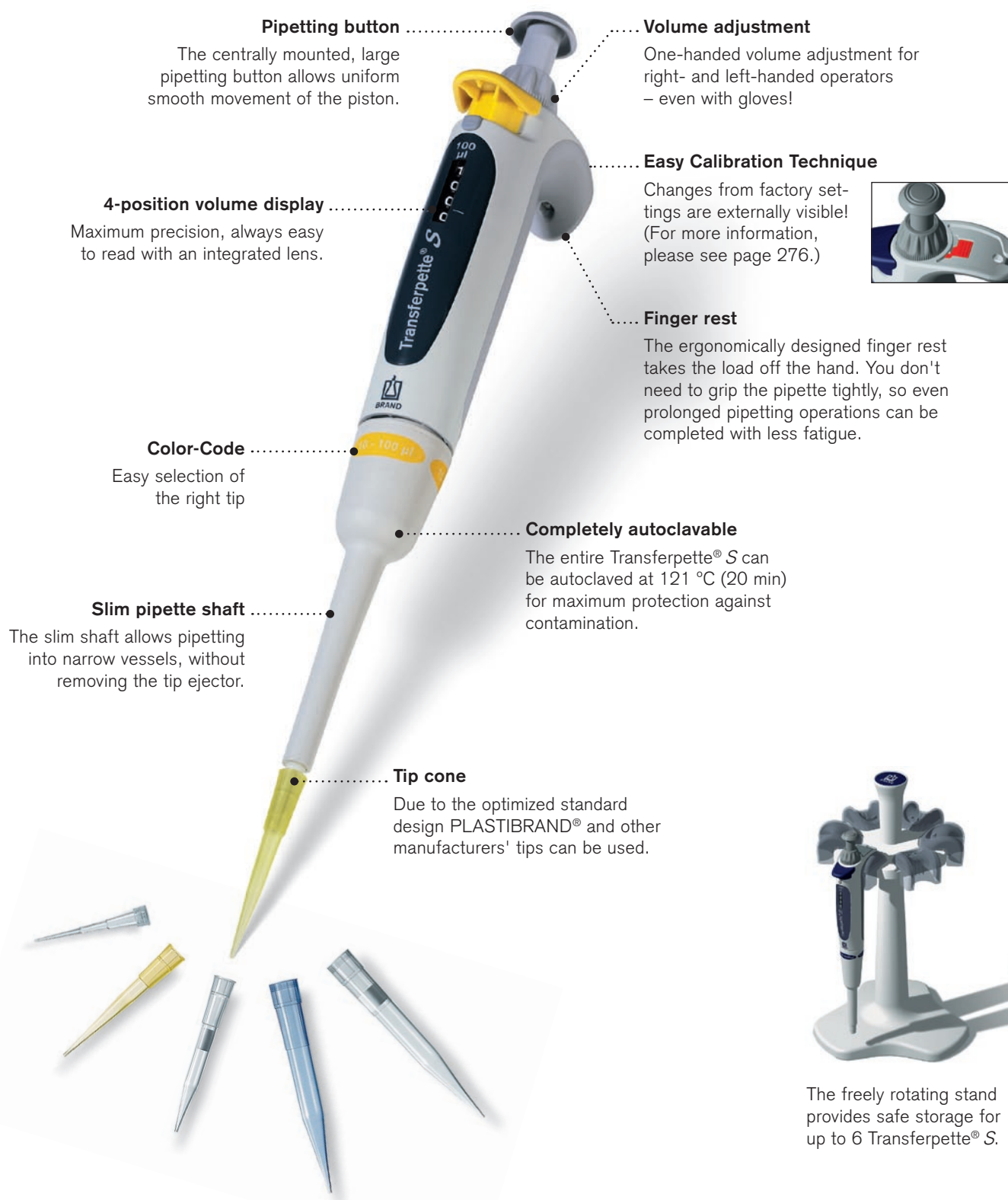

Ordering information



Transferpette® S, Digital adjustable

Items supplied:

Each Transferpette® S Digital adjustable pipette is conformity certified and supplied with performance certificate and rack mount.

Capacity μl		Description	A* ≤ ± %	μl	CV* ≤ %	μl	Subdivision μl	Cat. No.
0.1 -	1	D-1	2	0.02	1.2	0.012	0.001	7047 68
0.5 -	10	D-10	1	0.1	0.5	0.05	0.01	7047 70
2 -	20	D-20**	0.8	0.16	0.4	0.08	0.02	7047 72
10 -	100	D-100	0.6	0.6	0.2	0.2	0.1	7047 74
20 -	200	D-200**	0.6	1.2	0.2	0.4	0.2	7047 78
100 -	1000	D-1000	0.6	6	0.2	2	1	7047 80
500 -	5000	D-5000	0.6	30	0.2	10	5	7047 82
1000 -	10000	D-10000	0.6	60	0.2	20	10	7047 84

Transferpette® S, Fixed volume

Items supplied:

Each Transferpette® S Fixed volume pipette is conformity certified and supplied with performance certificate and rack mount.

Capacity μl	Description	A* ≤ ± %	μl	CV* ≤ %	μl	Cat. No.
10	F-10	1	0.1	0.5	0.05	7047 08
20	F-20**	0.8	0.16	0.4	0.08	7047 16
25	F-25	0.8	0.2	0.4	0.1	7047 20
50	F-50	0.8	0.4	0.4	0.2	7047 28
100	F-100	0.6	0.6	0.2	0.2	7047 38
200	F-200**	0.6	1.2	0.2	0.4	7047 44
500	F-500	0.6	3	0.2	1	7047 54
1000	F-1000	0.6	6	0.2	2	7047 62

* Calibrated to deliver (TD, Ex). Error limits according to the nominal capacity (= maximum volume) indicated on the instrument, obtained with instrument and distilled water at equilibrium with ambient temperature at 20 °C, and with smooth operation. A = Accuracy, CV = Coefficient of variation

** For use only with 2-200 μl pipette tips



Accessories

Starter Kit

Items supplied:

3 Transferpette® S Digital adjustable pipettes,
3 x Tip-Box (filled), 3 rack mounts.

Type	The kit includes the following Transferpette® S models	Cat. No.
Micro	D-1, D-10, D-100	7047 90
Midi	D-20, D-200, D-1000	7047 91
Macro	D-1000, D-5000, D-10000	7047 92

Shelf/rack mount

Shelf/rack mount for Transferpette® S single instrument. Pack of 1.

Cat. No.	7048 10
----------	---------

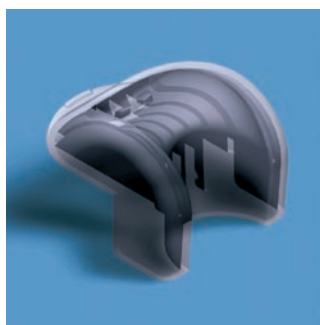

Bench-top rack

Suitable for up to 6 Transferpette® S pipettes. Pack of 1.

Cat. No.	7048 05
----------	---------





Transferpette®

Single-channel

The Transferpette® pipette from BRAND is designed for routine lab and research applications in a shape that is adapted to the anatomy of the human hand. The special handle shape with the side pipetting key allows the Transferpette® to lie loosely and lightly in your hand.

The Transferpette® is particularly well suited for prolonged pipetting, or for anyone who is susceptible to RSI syndrome due to repetitive laboratory procedures.



Models

Economical – accurate – versatile!

With only 5 instruments you can cover the entire volume range from 0.1 µl to 5 ml. You can choose from 10 models of the digital-adjustable Transferpette® and from 12 models of the fixed-volume type.



- Side pipetting key relieves strain; separate ejector function limits errors.
- Pipette shafts are entirely auto-clavable at 121 °C (20 min).
- Digital models feature Easy Calibration technique – readjustment without special tools (please see page 276 for further details).
- Corrosion-resistant piston and ejector
- Colored tip ejector caps indicate appropriate tips to use.
- Transferpette® 0.1-1 µl – maximum precision for molecular biology work, especially when pipetting enzymes.
- A variety of pipette stands for optimum storage of the Transferpette®
- CE-**IVD**-compliant



Transferpette® 0.1-1 µl
with nano-cap™ pipette tip



Optimal performance will be achieved with the use of genuine PLASTIBRAND® premium tips.
Pipette and filter tips,
see page 81-88.

A Closer Look...

The Transferpette® is designed to the shape of the human hand for maximum comfort.

Pipetting key

The side mounted pipetting key reduces hand fatigue, especially when performing serial pipetting operations.

Hand grip

The textured housing ensures a firm grip, and is UV resistant.

Volume adjustment

Changing volume is easy without snagging gloves. Detents prevent inadvertent volume changes.



Easy Calibration Technique

Calibration and adjustments according to ISO 9001 and GLP are done within seconds (for more information please see page 276).

Pipette shaft

The slim shaft (autoclavable at 121 °C) makes it possible to pipette in narrowest vessels without removing the tip ejector.

Tip cone

The taper is designed to fit PLASTIBRAND® and most other leading manufacturers tips.



Ordering Data

Transferpette®, Digital adjustable

Items supplied:

Each Transferpette® Digital adjustable is conformity certified and supplied with performance certificate.

Capacity µl	A* ≤ ± %	µl	CV* ≤ %	µl	Subdivision µl	Cat. No.
0.1 - 1	2	0.02	1.2	0.012	0.005	7041 01
0.5 - 10	1	0.1	0.8	0.08	0.05	7041 02
2 - 20	0.8	0.16	0.4	0.08	0.1	7041 03
2 - 20	0.8	0.16	0.4	0.08	0.1	7041 04
5 - 50	0.8	0.4	0.4	0.2	0.1	7041 72
10 - 100	0.6	0.6	0.2	0.2	0.1	7041 74
20 - 200	0.6	1.2	0.2	0.4	1	7041 78
25 - 250	0.6	1.5	0.2	0.5	1	7041 76
100 - 1000	0.6	6	0.2	2	1	7041 80
500 - 5000	0.6	30	0.2	10	10	7041 82

* Calibrated to deliver (TD, Ex). Error limits according to the nominal capacity (= maximum volume) indicated on the instrument, obtained with instrument and distilled water at equilibrium with ambient temperature at 20 °C, and with smooth operation. A = Accuracy, CV = Coefficient of variation



Transferpette®, Fixed volume

Items supplied:

Each Transferpette® Fixed volume is conformity certified and supplied with performance certificate and calibration key.

Capacity µl	A* ≤ ± %	µl	CV* ≤ %	µl	Cat. No.
5	1	0.05	0.8	0.04	7041 06
10	1	0.1	0.8	0.08	7041 08
20	0.8	0.16	0.4	0.08	7041 16
25	0.8	0.2	0.4	0.1	7041 20
50	0.8	0.4	0.4	0.2	7041 28
100	0.6	0.6	0.2	0.2	7041 38
200	0.6	1.2	0.2	0.4	7041 44
200	0.6	1.2	0.2	0.4	7041 46
250	0.6	1.5	0.2	0.5	7041 48
500	0.6	3	0.2	1	7041 54
1000	0.6	6	0.2	2	7041 62
2000	0.6	12	0.2	4	7041 64

* Calibrated to deliver (TD, Ex). Error limits according to the nominal capacity (= maximum volume) indicated on the instrument, obtained with instrument and distilled water at equilibrium with ambient temperature at 20 °C, and with smooth operation. A = Accuracy, CV = Coefficient of variation



BRAND also offers an on-site **calibration service** (for more information, please see page 273).

Accessories

PipSet Transferpette® Digital adjustable

The PipSet contains of three Transferpettes (0.5-10 µl, 10-100 µl, 100-1000 µl), one bench-top rack and one filled Tip Box N for each Transferpette®. Pack of 1.

Cat. No.	
	7041 90



Pipetting keys, colored

Incl. 2 stickers per key.
Pack of 5.

Color	Cat. No.
light green	7040 70
pink	7040 71
blue	7040 72
beige	7040 73
dark gray	7040 74
assorted colors	7040 75



Bench-top rack

Incl. 1 or 2 adapters
for Transferpette®
2 ml or 0.5-5 ml.
Pack of 1.



Description	Cat. No.
for 1 x 3 Transferpette® pipettes	7032 03
for 2 x 3 Transferpette® pipettes (Rondell)	7032 08

Wall/rack mount

Pack of 1.

Description	Cat. No.
for 1 x 3 Transferpette® pipettes*	7032 10

* Not suitable for the 0.5-5 ml or 2 ml Transferpette®

Individual stand

For Transferpette® 0.5-5 ml,
2 ml and Transferpette®
electronic 0.5-5 ml.
Pack of 1.

Cat. No.	
	7053 86



Transferpette®-8/-12

Multichannel

Repetitive multichannel pipetting can be tedious. Why make it more difficult than it needs to be? The Transferpette®-8/-12 requires much less effort than many conventional multichannel pipettes. Its light weight and ergonomic design help to reduce hand stress.

The tips are of equal importance to the instrument for pipetting accuracy and precision. BRAND manufactures tips to the same high quality standards as the instruments for optimum results. (For more information about pipette tips, see pages 81-88.)



Models

To make your work as easy as possible, the Transferpette®-8/-12 is available in 7 different volume ranges, from 0.5 µl to 300 µl... a model for every application!

- Resilient FKM V-rings and a stepped tip ejector significantly reduce tip-ejection force.
- Easy to maintain, with individual shafts and seals that can be removed and replaced for cleaning or repair in the lab, without special tools and without affecting calibration!
- Universal tip cone – fits all conventional pipette tips.
- Corrosion-resistant pistons
- Easy Calibration Technique: Make calibration adjustments yourself in half the time or less, without tools and without trial-and-error (for further information, please see page 276).
- The freely rotatable manifold can be entirely autoclaved at 121 °C.
- Separate ejector function reduces inadvertent ejector risk.
- CE-IVD-compliant



Individual shafts can easily be removed and replaced in the laboratory for convenient cleaning or economical repair.



Optimal performance will be achieved with the use of genuine PLASTIBRAND® premium tips. **Pipette and filter tips,** see page 81-88.

A Closer Look...

The Transferpette®-8/-12 is designed with ease of use in mind. The contoured handle and accessible controls work naturally in your hand. The light-weight yet durable construction and low operating force minimize strain and fatigue.

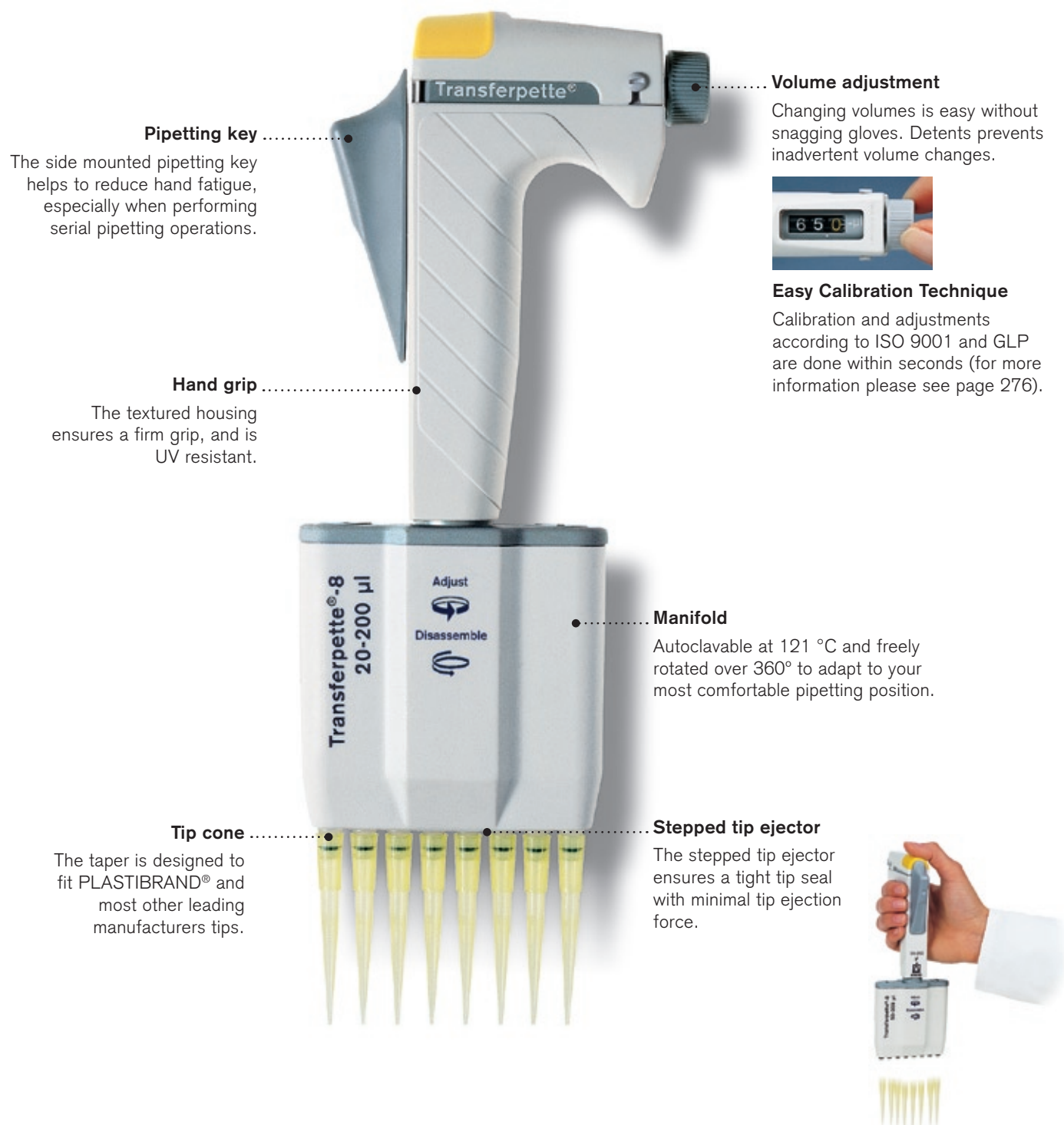

Ordering Data



Transferpette®-8

Items supplied:

Each Transferpette®-8 is conformity certified and supplied with performance certificate, 1 Tip-Box, filled with PLASTIBRAND® pipette tips, 1 Tip-Rack for refilling, 1 stand, 1 reagent-reservoir, 1 set of sealing rings made of FKM.

Capacity µl	A* ≤ ± %	µl	CV* ≤ %	µl	Subdivision µl	Cat. No.
0.5 - 10	1.6	0.16	1.0	0.1	0.05	7036 00
2 - 20	1.0	0.2	0.6	0.12	0.1	7036 02
2.5 - 25	1.0	0.25	0.6	0.15	0.1	7036 04
5 - 50	0.8	0.4	0.4	0.2	0.1	7036 06
10 - 100	0.8	0.8	0.3	0.3	0.1	7036 08
20 - 200	0.6	1.2	0.3	0.6	1	7036 10
30 - 300	0.6	1.8	0.3	0.9	1	7036 12

* Calibrated to deliver (TD, Ex). Error limits according to the nominal capacity (= maximum volume) indicated on the instrument, obtained with instrument and distilled water at equilibrium with ambient temperature at 20 °C, and with smooth operation. A = Accuracy, CV = Coefficient of variation



Transferpette®-12

Items supplied:

Each Transferpette®-12 is conformity certified and supplied with performance certificate, 1 Tip-Box, filled with PLASTIBRAND® pipette tips, 1 Tip-Rack for refilling, 1 stand, 1 reagent-reservoir, 1 spare set of sealing rings made of FKM.

Capacity µl	A* ≤ ± %	µl	CV* ≤ %	µl	Subdivision µl	Cat. No.
0.5 - 10	1.6	0.16	1.0	0.1	0.05	7036 20
2 - 20	1.0	0.2	0.6	0.12	0.1	7036 22
2.5 - 25	1.0	0.25	0.6	0.15	0.1	7036 24
5 - 50	0.8	0.4	0.4	0.2	0.1	7036 26
10 - 100	0.8	0.8	0.3	0.3	0.1	7036 28
20 - 200	0.6	1.2	0.3	0.6	1	7036 30
30 - 300	0.6	1.8	0.3	0.9	1	7036 32

* Calibrated to deliver (TD, Ex). Error limits according to the nominal capacity (= maximum volume) indicated on the instrument, obtained with instrument and distilled water at equilibrium with ambient temperature at 20 °C, and with smooth operation. A = Accuracy, CV = Coefficient of variation



Reagent reservoir,
PP, non-sterile or sterile,
please see page 55.



Transferpette® electronic

Single-channel

The Transferpette® electronic combines the widely recognized features of BRAND mechanical pipettes with the advantages of electronic apparatus. Comfortable design, balanced weight distribution, intuitive software and user-friendly technical documentation were the key objectives in developing the Transferpette® electronic.

TUV Rhineland/Berlin-Brandenburg has confirmed the design as ergonomically sound and easy to use after rigorous field testing. It was the first pipette ever granted such recognition as a comprehensive, ergonomic concept.

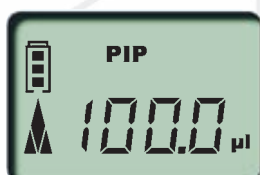

Models

Transferpette® electronic is available in 5 different models: 0.5-10 µl, 2-20 µl, 20-200 µl, 100-1000 µl and 0.5-5 ml.



■ Ergonomic

- functional, ergonomic housing design
- individually adjustable finger rest

■ Easy operation

- intuitive menu structure
- comprehensively illustrated user manual

■ Innovative

- significantly reduced tip attachment and ejection forces using universal tips

■ Five convenient programs

(Please see page 48 for details)

- Pipetting
- Reverse pipetting
- Mixing
- GEL-Electrophoresis
- Dispensing

■ Ready for use

- 4000 pipetting cycles with each battery charge
- battery refresh function

■ CE-IVD-compliant



Optimal performance will be achieved with the use of genuine PLASTIBRAND® premium tips. **Pipette and filter tips**, see pages 81-88.

A Closer Look...

The Transferpette® electronic was **the first microliter pipette worldwide** to be recognized with the "Ergonomics Approved" certificate from the Technical Control Board Rhineland/Berlin-Brandenburg!

Independent user tests confirm the ergonomics and the operating ease of the product and system!

A user acceptance rating of **1.54** is an outstanding result.

You can obtain information about the Transferpette® electronic at www.tuv.com, ID No. 0011105500.



Functions

The Programs



Pipetting (PIP Mode)

The "standard" program.
The set volume is aspirated by the pipette,
and then discharged.



Mixing of Samples (PIPMix Mode)

Program for mixing of liquids. The sample is
repeatedly aspirated and discharged, and the
number of mixing cycles is displayed.



Reverse Pipetting (revPIP Mode)

Program specially designed for the pipetting
of liquids with a high viscosity, high vapor
pressure or foamy media.



Pipetting with Electrophoresis (GEL Mode)*

Program for the loading of electrophoresis gels**.
The required sample volume is aspirated at the desired,
adjustable speed, and is then discharged very slowly.
The exact volume of liquid discharged is shown in the
display as it is discharged.



Dispensing (DISP Mode)

A program for the dispensing of liquids in a series
of equal aliquots. A volume that has been aspirated
is dispensed in steps.



Easy Calibration Technique (CAL Mode)

Program for making quick adjustments to the
Transferpette® electronic, without tools. By changing
the factory setting, <CAL> appears automatically in the
display (please see page 276 for more information).

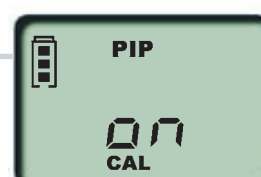

Battery-Refresh (batt Mode)

Regeneration function for increased performance and
extending the service life of the batteries. The world's
first microliter pipette with this function.



* The GEL mode is not included in the Transferpette® electronic 1000 µl and 5000 µl
because these volumes are rarely used in electrophoresis.

** Patent pending

Ordering Data

Transferpette® electronic

Items supplied:

Each Transferpette® electronic is conformity certified and supplied with performance certificate, battery, battery charger, 2 extra ejector clips to adapt to non-standard tips (for Transferpette® electronic 20-200 µl, 100-1000 µl), silicon oil.

Capacity µl	Subdiv. µl	A* ≤ ± %		CV* ≤ %		Tip type µl	With battery charger for	Cat. No.
0.5 - 10	0.01	1.0	0.1	0.4	0.04	20	Europe (continental) (230V/50Hz)	7052 99
							UK/Ireland (230V/50Hz)	7053 09
							USA/Japan (110V/50-60Hz)	7053 19
							Australia (240V/50Hz)	7053 29
							without battery charger	7053 39
2 - 20	0.02	1.0	0.2	0.4	0.08	20	Europe (continent) (230V/50Hz)	7053 00
							UK/Ireland (230V/50Hz)	7053 10
							USA/Japan (110V/50-60Hz)	7053 20
							Australia (240V/50Hz)	7053 30
							without battery charger	7053 40
20 - 200	0.2	0.8	1.6	0.2	0.4	200/300	Europe (continent) (230V/50Hz)	7053 03
							UK/Ireland (230V/50Hz)	7053 13
							USA/Japan (110V/50-60Hz)	7053 23
							Australia (240V/50Hz)	7053 33
							without battery charger	7053 43
100 - 1000	1.0	0.6	6	0.2	2	1000	Europe (continent) (230V/50Hz)	7053 06
							UK/Ireland (230V/50Hz)	7053 16
							USA/Japan (110V/50-60Hz)	7053 26
							Australia (240V/50Hz)	7053 36
							without battery charger	7053 46
500 - 5000	5.0	0.6	30	0.2	10	5000	Europe (continent) (230V/50Hz)	7053 07
							UK/Ireland (230V/50Hz)	7053 17
							USA/Japan (110V/50-60Hz)	7053 27
							Australia (240V/50Hz)	7053 37
							without battery charger	7053 47

* Calibrated to deliver (TD, Ex). Error limits according to the nominal capacity (= maximum volume) indicated on the instrument, obtained with instrument and distilled water at equilibrium with ambient temperature at 20 °C, and with smooth operation. A = Accuracy, CV = Coefficient of variation



Accessories

3-device charging stand for Transferpette® electronic

Pack of 1.

for Transferpette® electronic with battery charger for	Cat. No.
Europe (continental)	7053 90
UK/Ireland	7053 91
USA/Japan	7053 92
Australia	7053 93



Individual stand for Transferpette® electronic

Pack of 1.

for Transferpette® electronic	Cat. No.
up to 1000 µl	7053 85
500-5000 µl	7053 86





Transferpette®-8/-12 electronic Multichannel

The operation of 8- or 12-channels simultaneously multiplies the risk of RSI if the forces are not properly managed.

Simply tap the pipette key: uniform, negligible operating force during pipetting, together with drastically reduced ejection force, makes all the difference in the Transferpette®-8/-12 electronic.

Models

Transferpette®-8/-12 electronic is available in 5 different models: 0.5-10 µl, 1-20 µl, 5-100 µl, 10-200 µl and 15-300 µl.



■ Ergonomic

- functional, ergonomic housing design
- individually adjustable finger rest

■ Easy Operation

- intuitive menu structure
- comprehensively illustrated user manual

■ Innovative

- significantly reduced tip attachment and ejection forces

■ Five convenient programs

(Please see page 48 for details.)

- Pipetting
- Reverse pipetting
- Mixing
- GEL-Electrophoresis
- Dispensing

■ Ready for Use

- 4000 pipetting cycles with each battery charge
- battery refresh function

■ CE-IVD-compliant



Optimal performance will be achieved with the use of genuine PLASTIBRAND® premium tips.
Pipette and filter tips, see pages 81-88.

A Closer Look...

The optimal position of the thumb relative to the functional elements of the pipette is the starting point for a relaxed grip. RSI is the keyword.

The optimum design, the layout of the controls, and the adjustable finger rest provide a Transferpette®-8/-12 that fits the hand like a glove. Perfect for right-handers and left-handers alike!

The Transferpette®-8/-12 electronic received the Ergonomics Certificate as the world's first electronic multichannel pipette with a User Acceptance Rating of 1.55 – unrivaled anywhere!



Charging connector jack

Large, clear display, with easily understandable numbers, words and symbols.

Intuitive operation of all functions using menu keys.

Ergonomically arranged ejection button with color code for pipette volume and tip size.

Individually adjustable finger rest

Complete manifold can be autoclaved at 121 °C and rotates freely 360°.

Stepped tip ejector reduces ejection forces significantly.

V-rings made of FKM allow effortless mounting and easy ejection of the tips, and readily adapt to tips from various manufacturers.

Easy to Service



The manifold for the Transferpette®-8/-12 electronic has been completely newly developed.

Individual shafts and seals can now be easily removed and replaced in the lab for cleaning or repair without tools or calibration adjustments! Tip cones and seals can now be easily cleaned or replaced. This patented procedure eliminates the expense and long outages providing long service life and low operating costs.

No readjustment necessary.



Save Work

Shafts and sealing rings are made of resilient FKM material, and are designed so that only minimal attachment force is needed for solid and parallel tip seating. The stepped design allows the ejection force to be sequentially distributed to the tips within fractions of a second and thus drastically reduces the force required.



Stepped surface

Sealing ring of FKM

Ordering Data

Transferpette®-8 electronic

Items supplied:

Each Transferpette®-8 electronic is conformity certified and supplied with performance certificate, battery, battery charger, device stand, Tip-Box SL, refill units, reagent reservoir and silicone oil.



Capacity μl	Subdiv. μl	A* ≤ ±		CV* ≤		Tip type μl	With battery charger for	Cat. No.
0.5 - 10	0.01	1.2	0.12	0.8	0.08	20	Europe (continental) (230V/50Hz)	7053 99
							UK/Ireland (230V/50Hz)	7054 09
							USA/Japan (110V/50-60Hz)	7054 19
							Australia (240V/50Hz)	7054 29
1 - 20	0.02	1.0	0.2	0.5	0.1	20	Europe (continental) (230V/50Hz)	7054 00
							UK/Ireland (230V/50Hz)	7054 10
							USA/Japan (110V/50-60Hz)	7054 20
							Australia (240V/50Hz)	7054 30
5 - 100	0.1	0.8	0.8	0.25	0.25	200/300	Europe (continental) (230V/50Hz)	7054 03
							UK/Ireland (230V/50Hz)	7054 13
							USA/Japan (110V/50-60Hz)	7054 23
							Australia (240V/50Hz)	7054 33
10 - 200	0.2	0.8	1.6	0.25	0.5	200/300	Europe (continental) (230V/50Hz)	7054 04
							UK/Ireland (230V/50Hz)	7054 14
							USA/Japan (110V/50-60Hz)	7054 24
							Australia (240V/50Hz)	7054 34
15 - 300	0.5	0.6	1.8	0.25	0.75	300	Europe (continental) (230V/50Hz)	7054 06
							UK/Ireland (230V/50Hz)	7054 16
							USA/Japan (110V/50-60Hz)	7054 26
							Australia (240V/50Hz)	7054 36

* Calibrated to deliver (TD, Ex). Error limits according to the nominal capacity (= maximum volume) indicated on the instrument, obtained with instrument and distilled water at equilibrium with ambient temperature at 20 °C, and with smooth operation. A = Accuracy, CV = Coefficient of variation

Transferpette®-12 electronic

Items supplied:

Each Transferpette®-12 electronic is conformity certified and supplied with performance certificate, battery, battery charger, device stand, Tip-Box SL, refill units, reagent reservoir and silicone oil.

Capacity μl	Subdiv. μl	A* ≤ ± % μl	CV* ≤ % μl	Tip type μl	With battery charger for	Cat. No.
0.5 - 10	0.01	1.2 0.12	0.8 0.08	20	Europe (continental) (230V/50Hz)	7054 49
					UK/Ireland (230V/50Hz)	7054 59
					USA/Japan (110V/50-60Hz)	7054 69
					Australia (240V/50Hz)	7054 79
1 - 20	0.02	1.0 0.2	0.5 0.1	20	Europe (continental) (230V/50Hz)	7054 50
					UK/Ireland (230V/50Hz)	7054 60
					USA/Japan (110V/50-60Hz)	7054 70
					Australia (240V/50Hz)	7054 80
5 - 100	0.1	0.8 0.8	0.25 0.25	200/300	Europe (continental) (230V/50Hz)	7054 53
					UK/Ireland (230V/50Hz)	7054 63
					USA/Japan (110V/50-60Hz)	7054 73
					Australia (240V/50Hz)	7054 83
10 - 200	0.2	0.8 1.6	0.25 0.5	200/300	Europe (continental) (230V/50Hz)	7054 54
					UK/Ireland (230V/50Hz)	7054 64
					USA/Japan (110V/50-60Hz)	7054 74
					Australia (240V/50Hz)	7054 84
15 - 300	0.5	0.6 1.8	0.25 0.75	300	Europe (continental) (230V/50Hz)	7054 56
					UK/Ireland (230V/50Hz)	7054 66
					USA/Japan (110V/50-60Hz)	7054 76
					Australia (240V/50Hz)	7054 86

* Calibrated to deliver (TD, Ex). Error limits according to the nominal capacity (= maximum volume) indicated on the instrument, obtained with instrument and distilled water at equilibrium with ambient temperature at 20 °C, and with smooth operation. A = Accuracy, CV = Coefficient of variation



Accessories



Reagent reservoir

PP, high clarity.
Capacity 60 ml.
Autoclavable (121 °C).

Non-sterile, with lid.
Pack of 10.

Cat. No. 7034 59

Sterile, without lid.
Packed individually.
Pack of 100.

Cat. No. 7034 11

Sterile, without lid.
5 per bag, pack of 200.

Cat. No. 7034 09

The right pipette tip for your Transferpette®

PLASTIBRAND® pipette tips are tested for BRAND and most of the pipette types of Gilson®, Thermo Electron (Finnpipette®), Eppendorf® and Biohit. The 5 ml tip is exclusively tested for BRAND and Thermo Electron (Finnpipette®). The 10 ml tip is suitable for BRAND, Eppendorf® and Gilson®.



		Transferpette® electronic* Transferpette® S Transferpette® Nominal volume											Transferpette®-8/-12 electronic* Transferpette®-8/-12 Nominal volume						
		1 µl	10 µl	20 µl	20 µl**	50 µl	100 µl	200 µl	250 µl	1000 µl	5 ml	10 ml	10 µl	20 µl	25 µl	50 µl	100 µl	200 µl	300 µl
Pipette tips Volume range	0.1 - 20 µl	✓	✓	✓									✓	✓					
	0.5 - 20 µl		✓	✓									✓	✓					
	2 - 200 µl				✓	✓	✓	✓							✓	✓	✓	✓	✓
	5 - 300 µl				✓	✓	✓	✓							✓	✓	✓	✓	✓
	50 - 1000 µl								✓	✓									
	50 - 1250 µl								✓	✓									
	0.5 - 5 ml										✓								
	1 - 10 ml												✓						
Filter tips Volume range	0.5 - 10 µl		✓	✓									✓	✓					
	2 - 20 µl				✓	✓	✓	✓							✓	✓	✓	✓	
	5 - 100 µl				✓	✓	✓	✓							✓	✓	✓	✓	✓
	5 - 200 µl							✓							✓	✓	✓	✓	✓
	50 - 1000 µl									✓									

✓ = Tip volume less than pipettes nominal volume

* Transferpette® electronic is not available in all specified volumes

** Transferpette® with yellow color code